

PMG Straight Plug, Key(G) Screw Locking and Cable Collet

- Connector series: PMG
- Contact: Male
- Key: G(More keys, refer to page 66)
- Locking type: Screw locking
- Orientation type: Straight
- Part No.: PMG.xK.3xx.CLAC(Z)
- Mated with: FMG.XK.3XX.CLL

Note: "X" refers to part number definition on page 48

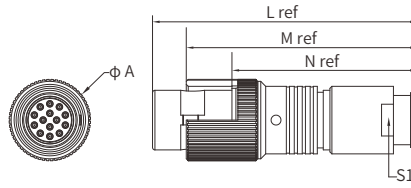

General Information

Ambient temperature:	-55°C ~ + 200°C
Endurance:	>3000 cycles
Insulator:	PEEK
Connector contacts:	Brass with gold plated
Housing:	Brass with Cr plated

Gasket:	Silicone
Insulator resistance:	≥100MΩ
IP rating:	IP 68
Shielding efficiency:	at 10MHz>95dB/at 1GHz>80dB
Salt spray corrosion test:	>144h

Size	Dimensions(mm)				
	A	L	M	N	S1
2K	20.5	66.7	58.2	46.7	15
3K	20.5	59.7	51.2	44.2	12

FJG Fixed Socket With Square Flange, Key(G) or (a To F, L And R), Protruding Shell And Earthing Tag

- Connector series: FJG
- Contact: Female
- Key: G(More keys, refer to page 66)
- Locking type: Self-locking
- Orientation type: Straight
- Part No.: FJG.3K.3xx.xLL
- Mated with: PSG

Note: "X" refers to part number definition on page 48

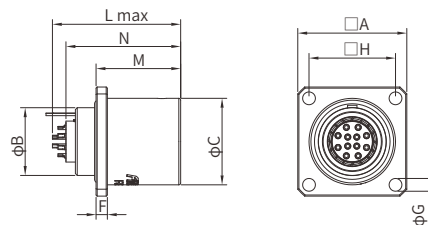

General Information

Ambient temperature:	-55°C ~ + 200°C
Endurance:	>5000 cycles
Insulator:	PEEK
Connector contacts:	Brass with gold plated
Housing:	Brass with Cr plated

Gasket:	Silicone
Insulator resistance:	≥100MΩ
IP rating:	IP 68
Shielding efficiency:	at 10MHz>95dB/at 1GHz>80dB
Salt spray corrosion test:	>144h

Size	Dimensions(mm)								
	A	B	C	F	G	H	L	M	N ¹⁾
3K	29	18	23	3	3.4	23	36.2	22.5	32.6

Note: 1) maximum length with crimp contacts Panel cut-out (page 164)